

ISOMETRIC
CUSTOMER SIDE - ADA SHELF IN

SHOP NOTES:

1. FULLY WELD, GRIND AND POLISH SMOOTH ALL VISIBLE METAL. EASE ALL METAL EDGES.
 2. ALL SEAMS IN WOOD AND METAL TO BE A TIGHT FIT AND FLUSH FOR CLEAN LOOK. NO GAPS. CAULK WHERE NECESSARY.
 3. NO UNFINISHED EDGES, SEAMS OR REVEALS.
 4. PLEXIGLASS POLISHED AT ALL EDGES.
- ALL GROUT LINES SHOWN AT 1/8". RECOMMENDED MINIMUM OF .08" TILE SHOWN IN DETAILS IS 1/4" THICK. THIS INCLUDES MASTIC/ADHESIVE. ACTUAL TILE IS SLIGHTLY THINNER (.22")

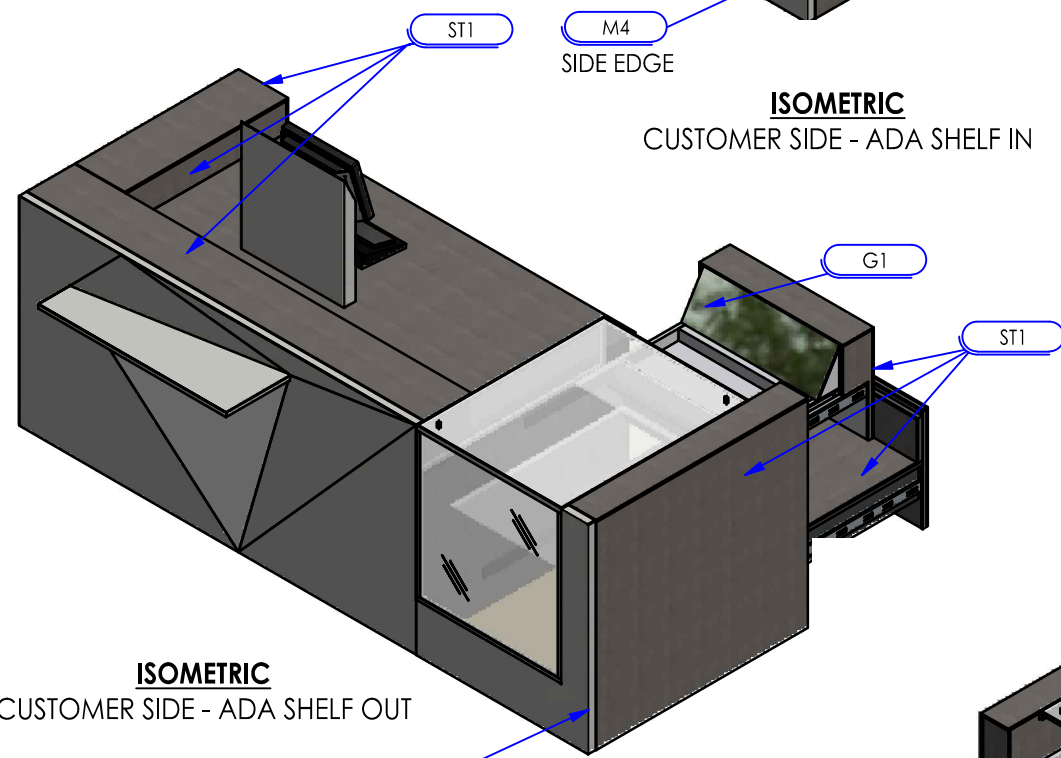

ISOMETRIC
CUSTOMER SIDE - ADA SHELF OUT

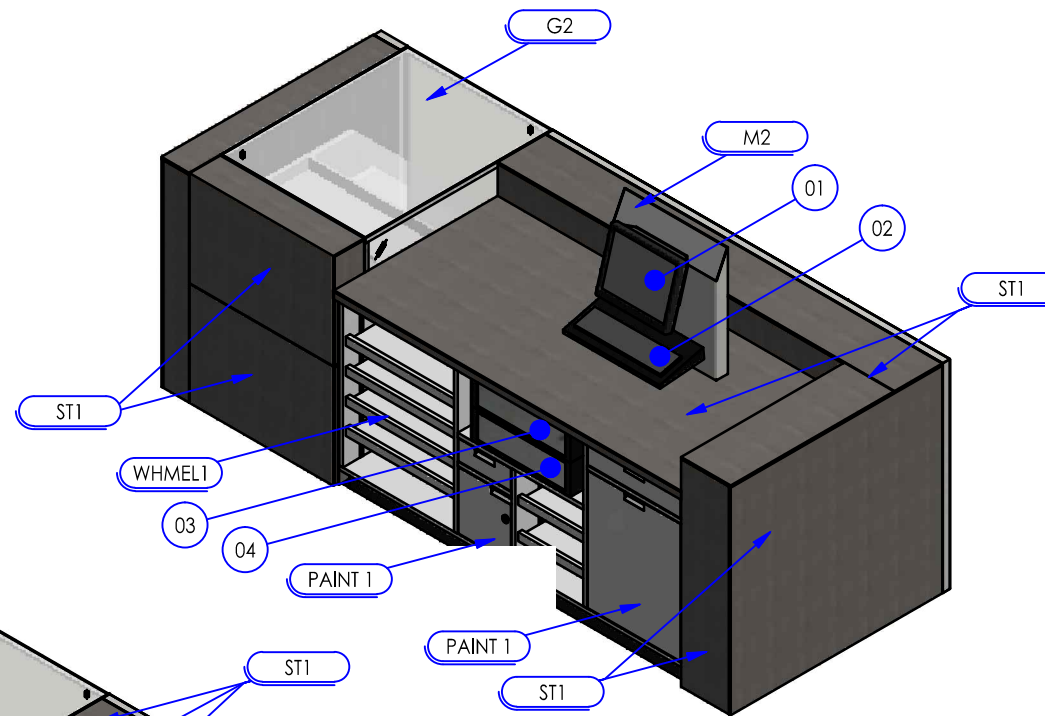

ISOMETRIC
CLERK SIDE - DRAWERS IN

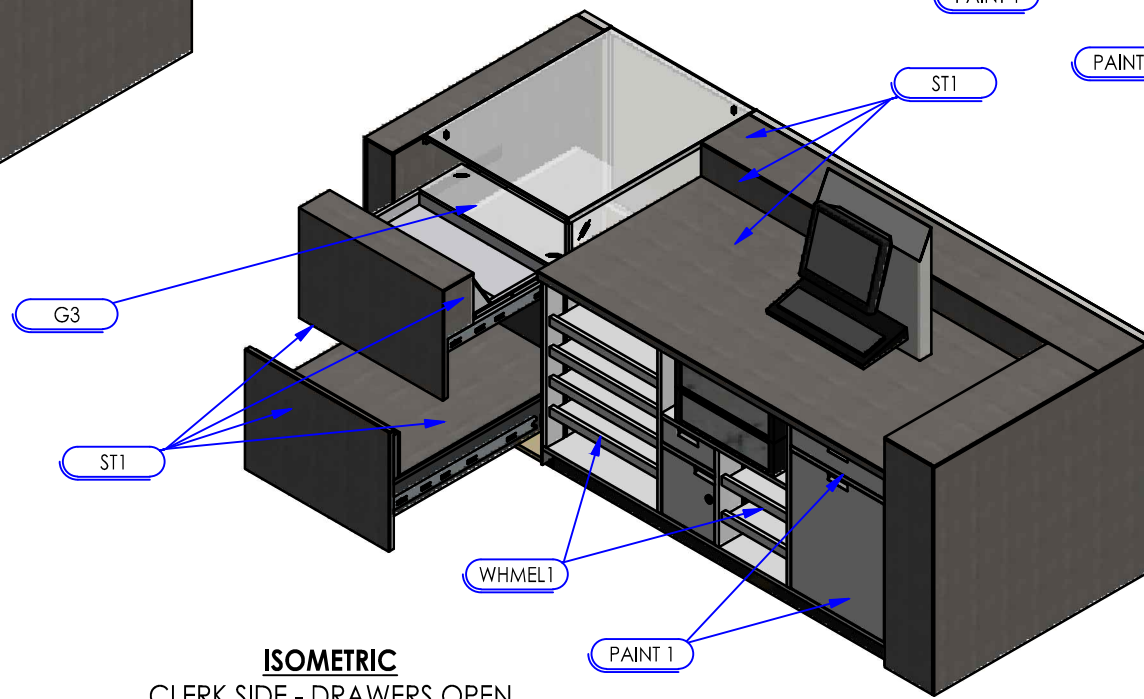

ISOMETRIC
CLERK SIDE - DRAWERS OPEN

RETAIL



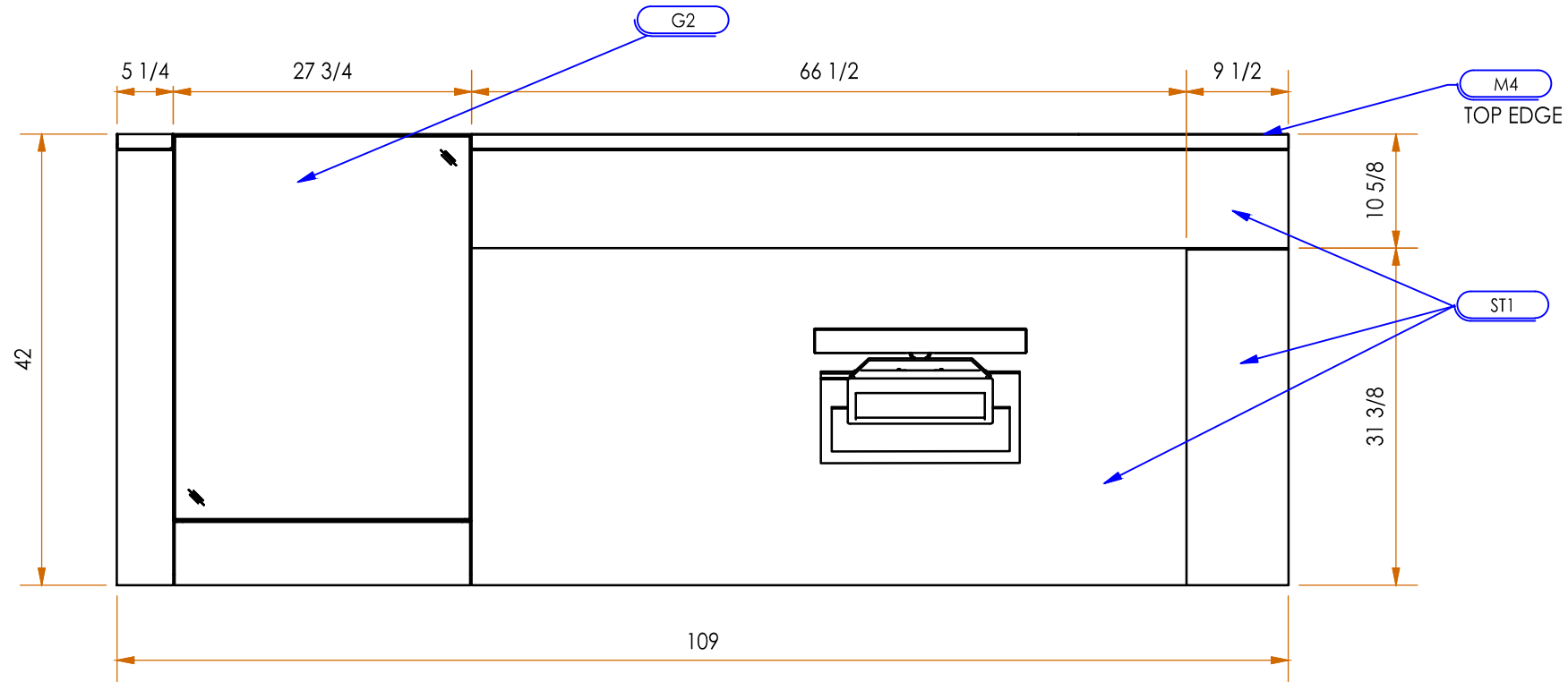

PLAN VIEW

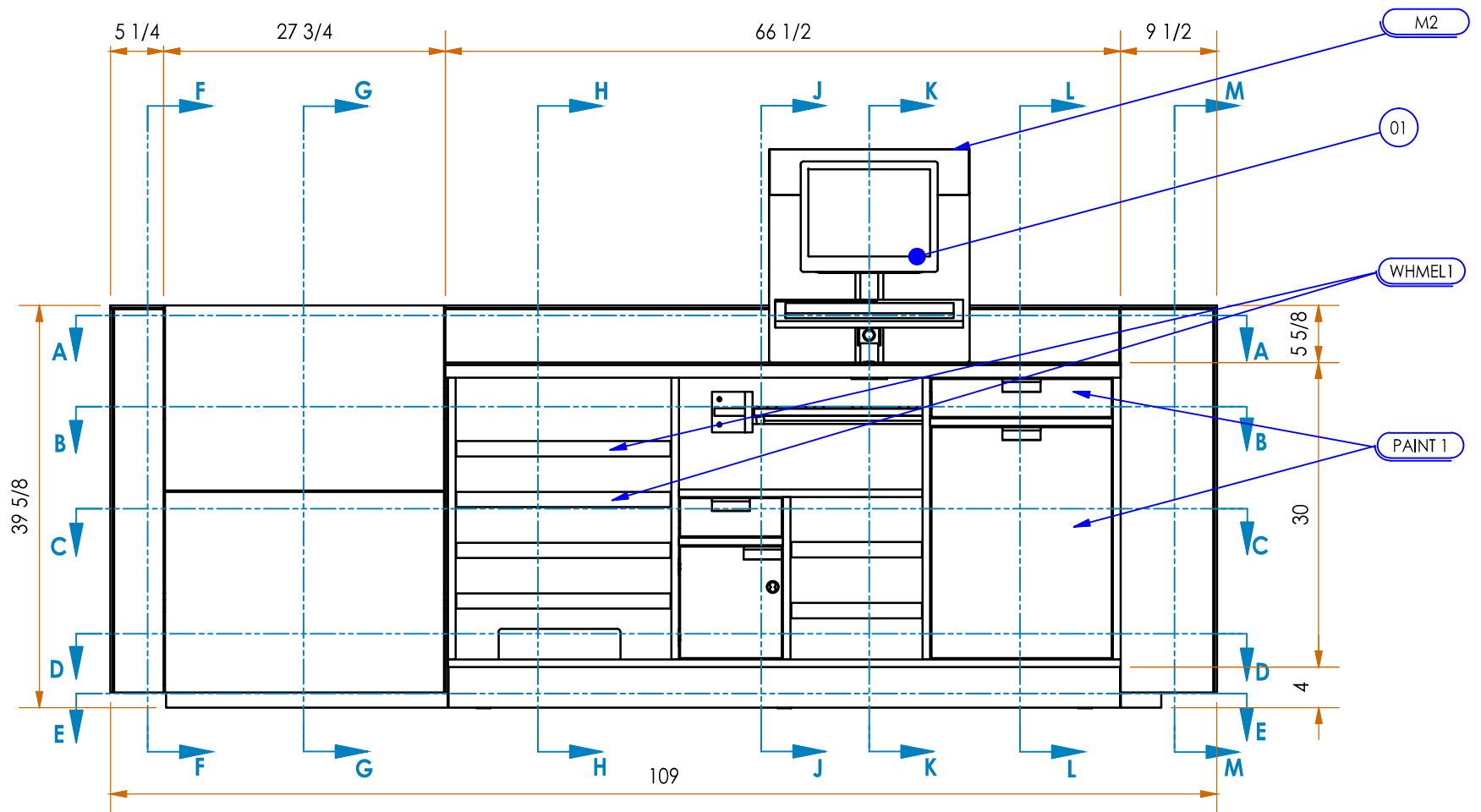

ELEVATION CLERK SIDE

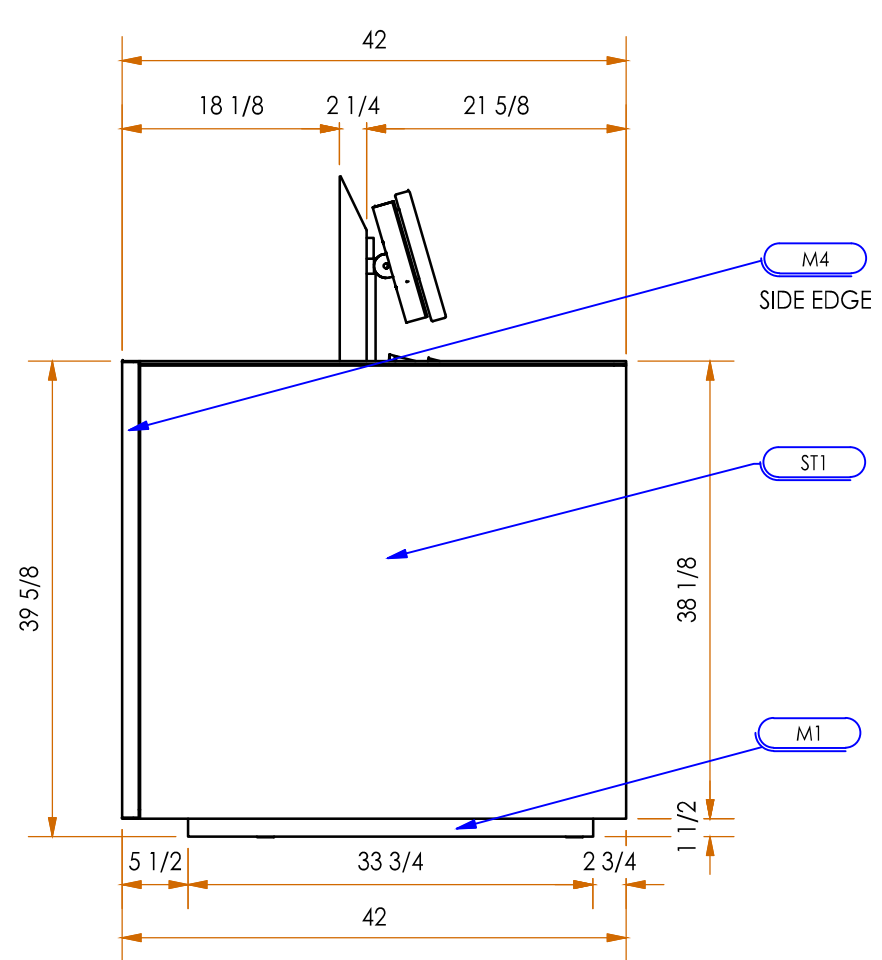

RIGHT ELEVATION

RETAIL

blacks outsourcing, inc.
 Architectural Woodwork Engineering
 Our business is drawing yours



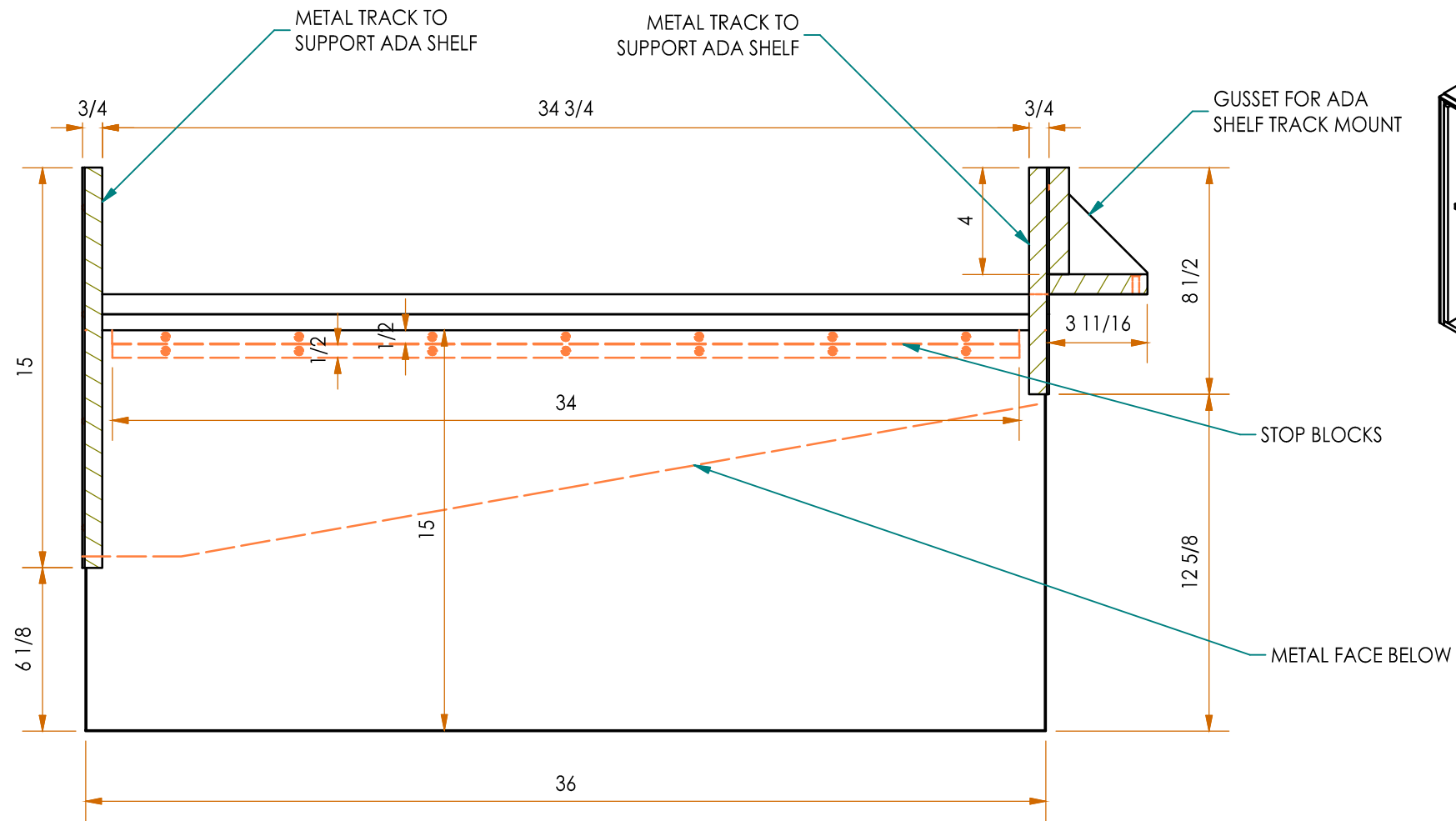

PLAN VIEW
ADA SHELF

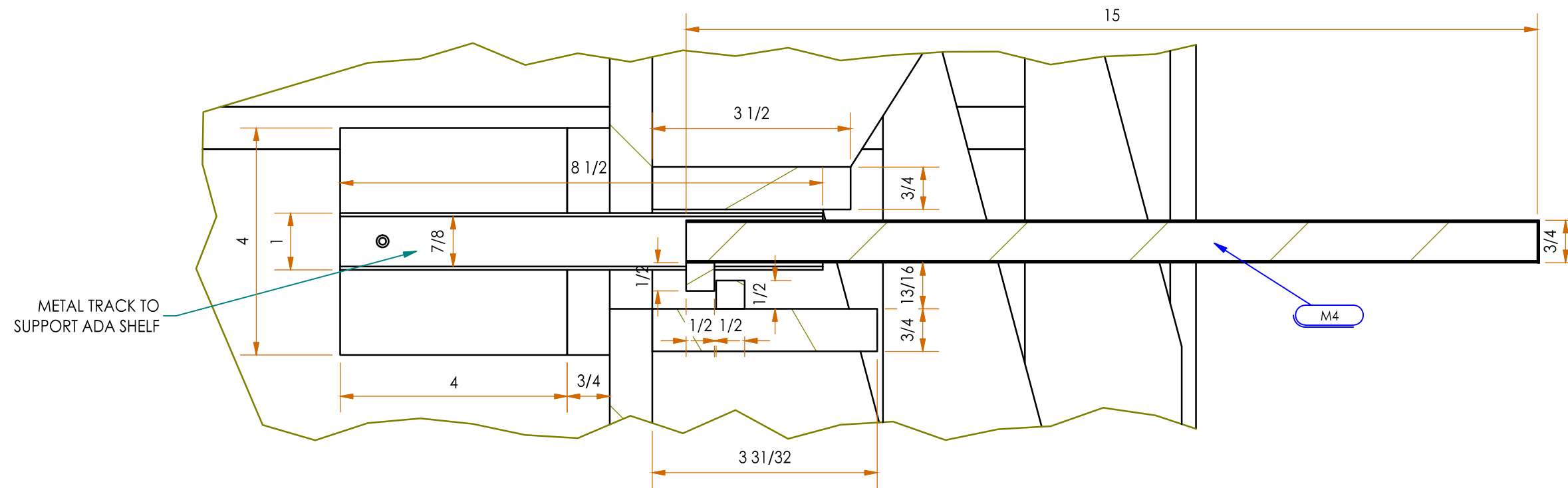
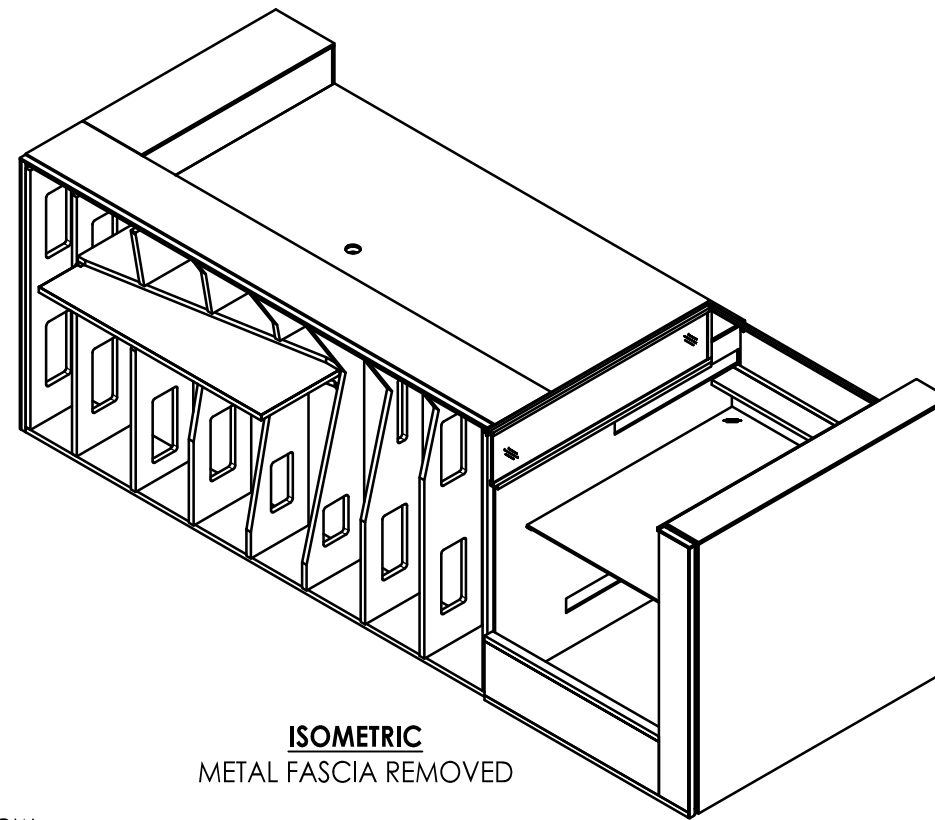

ADA SHELF DETAIL

RETAIL



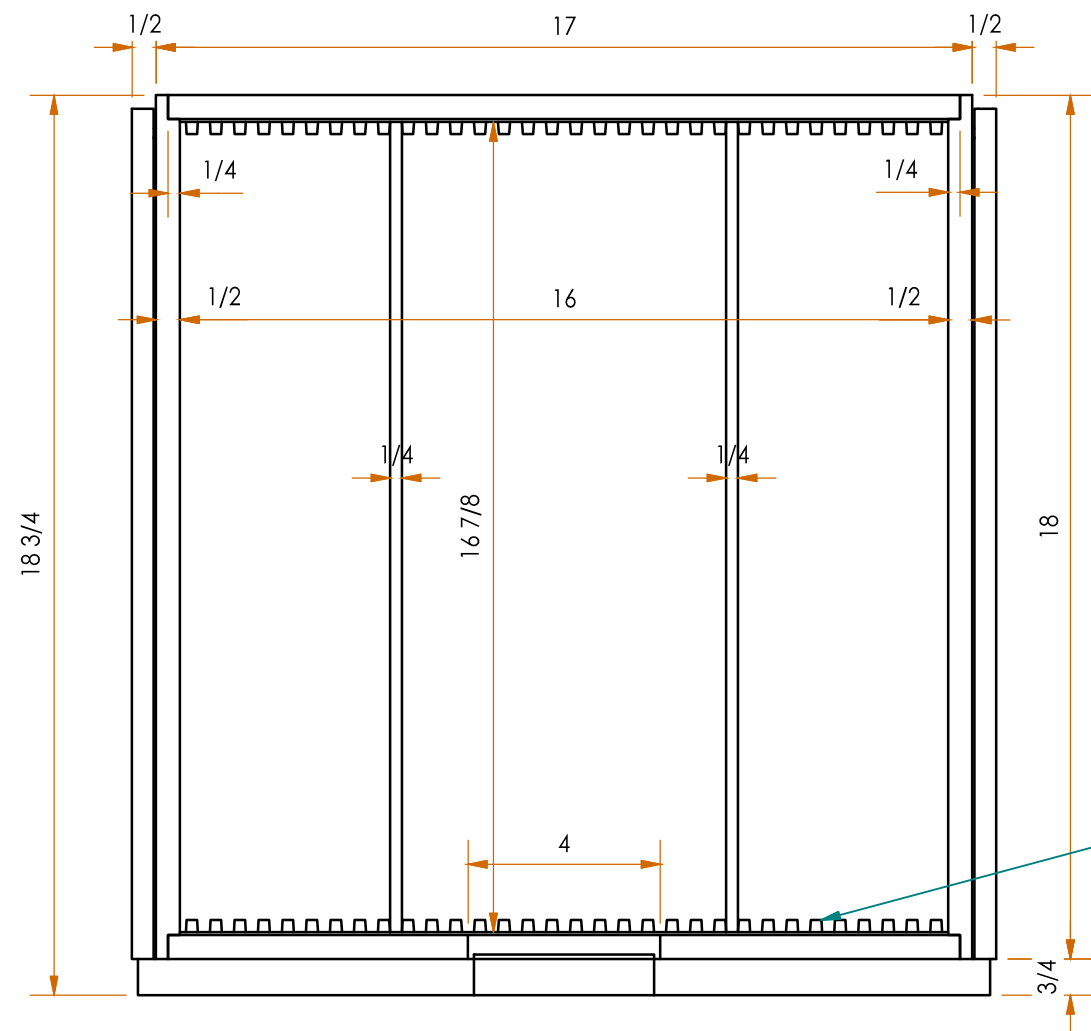

PLAN VIEW

BINNING STRIPS

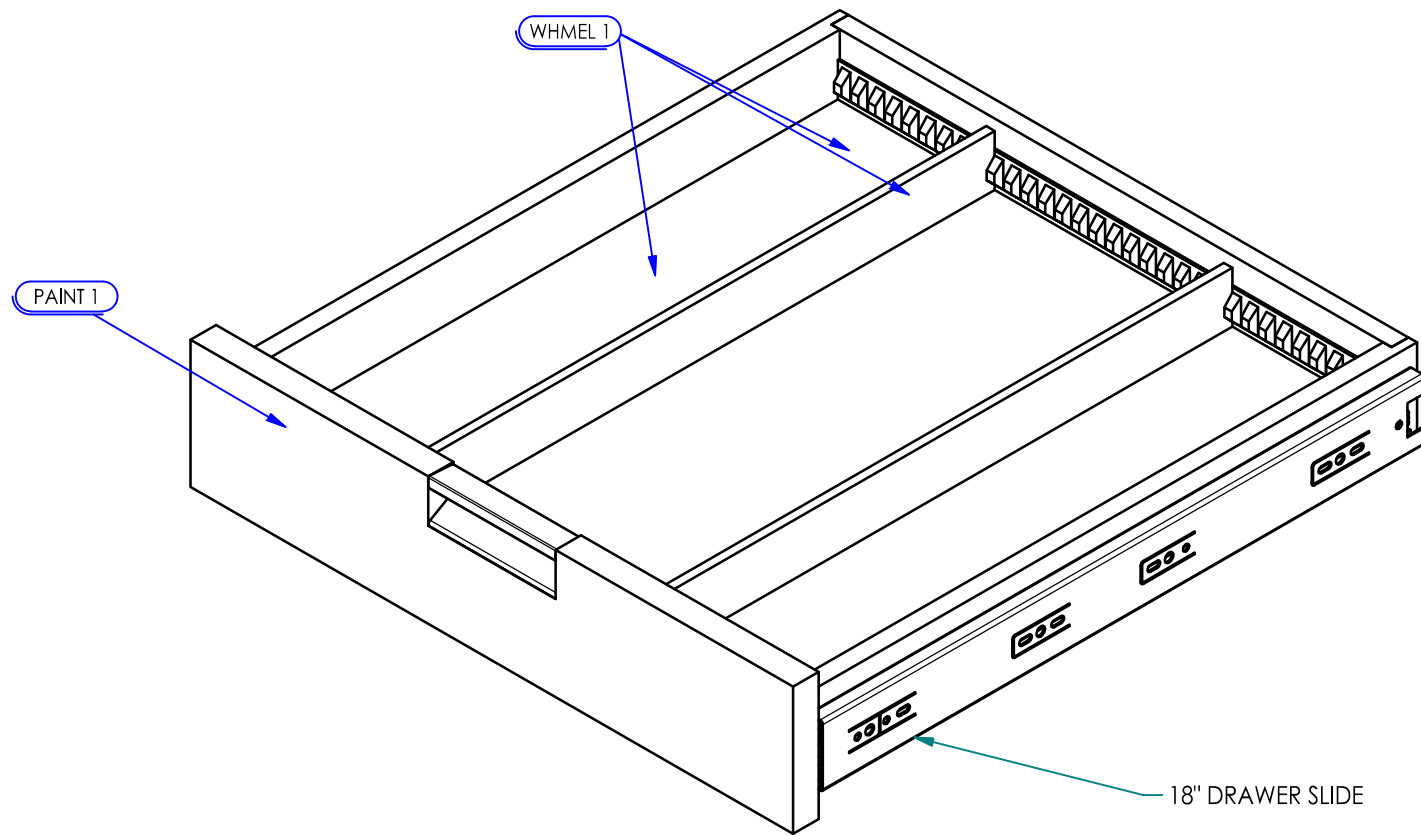

**ISOMETRIC
DRAWER**

18" DRAWER SLIDE

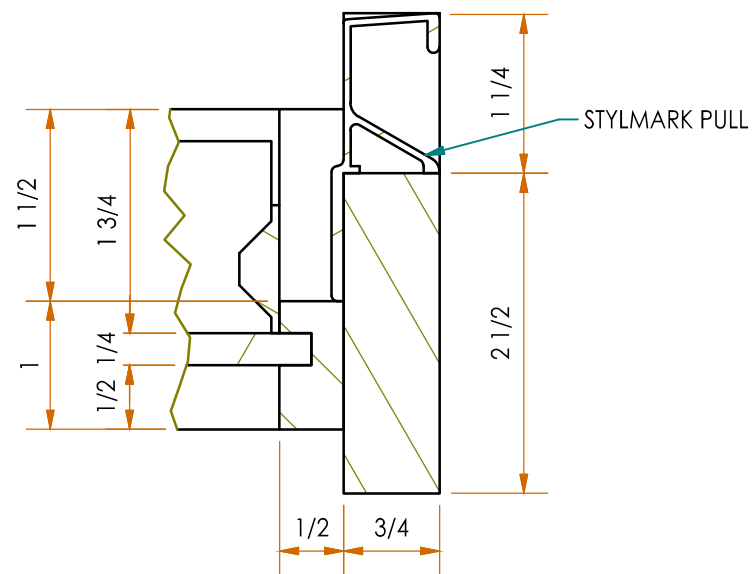

DETAIL 8

STYLMARK PULL

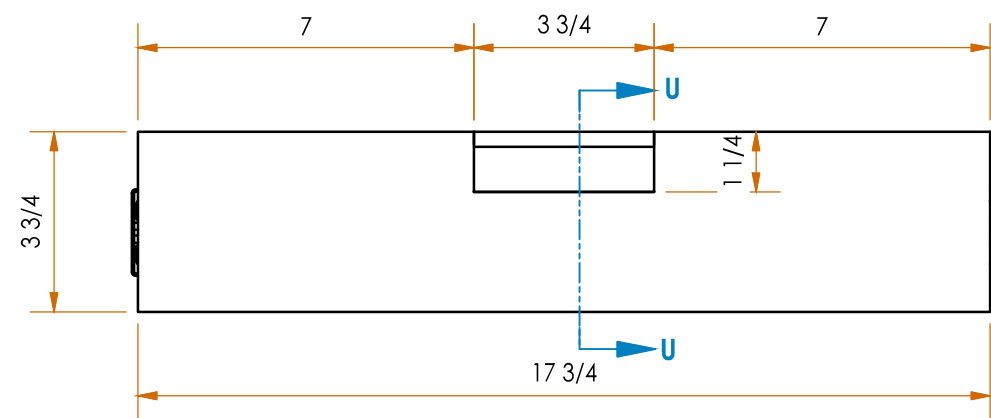

ELEVATION

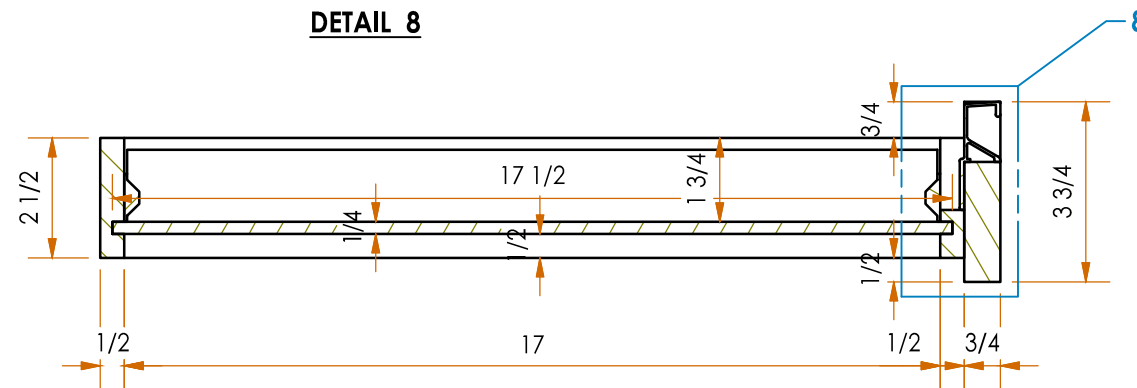

SECTION U-U

RETAIL

blacks outsourcing, inc.
Architectural Woodwork Engineering
Our business is drawing yours

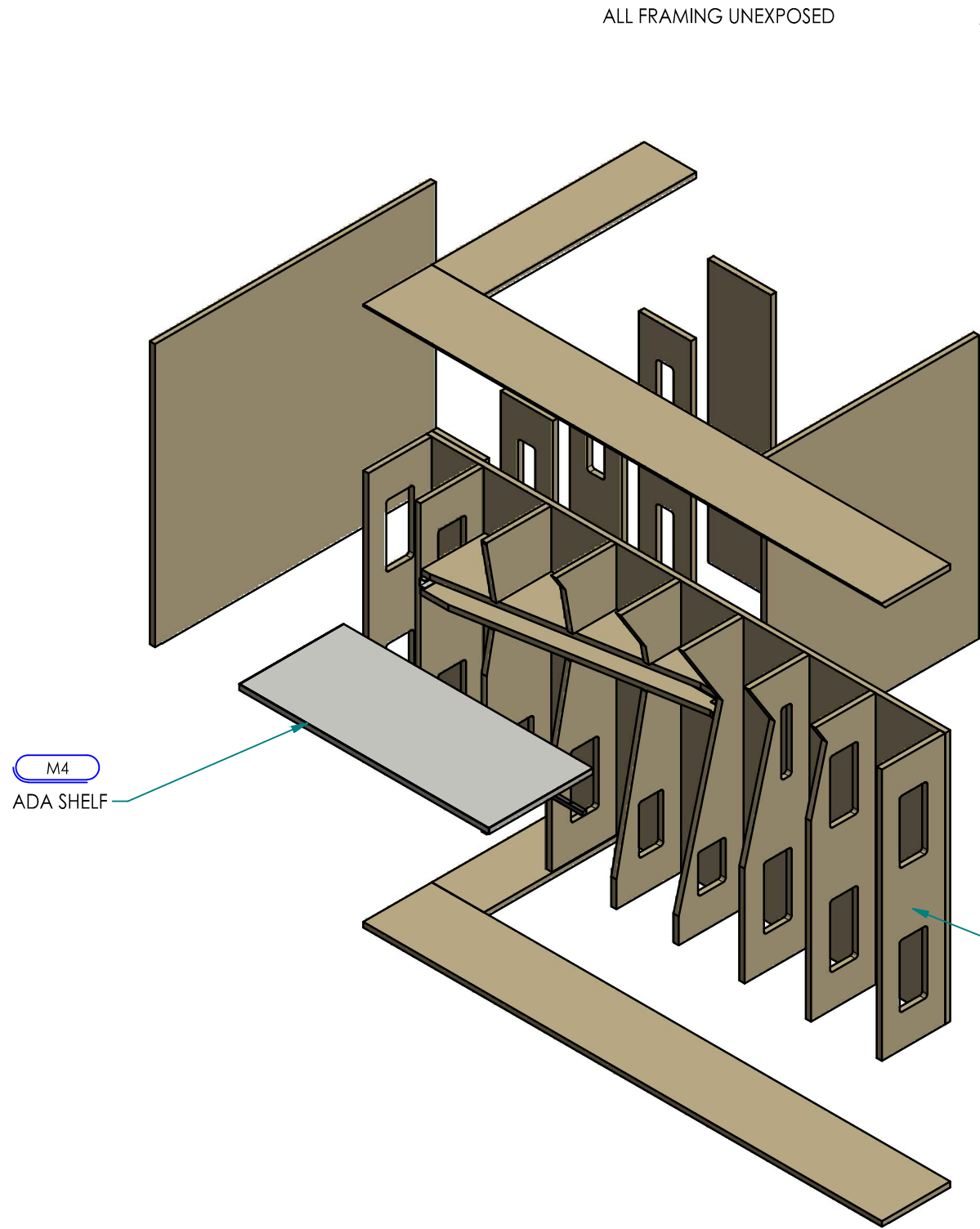

**EXPLODED ISOMETRIC
FRAMING**

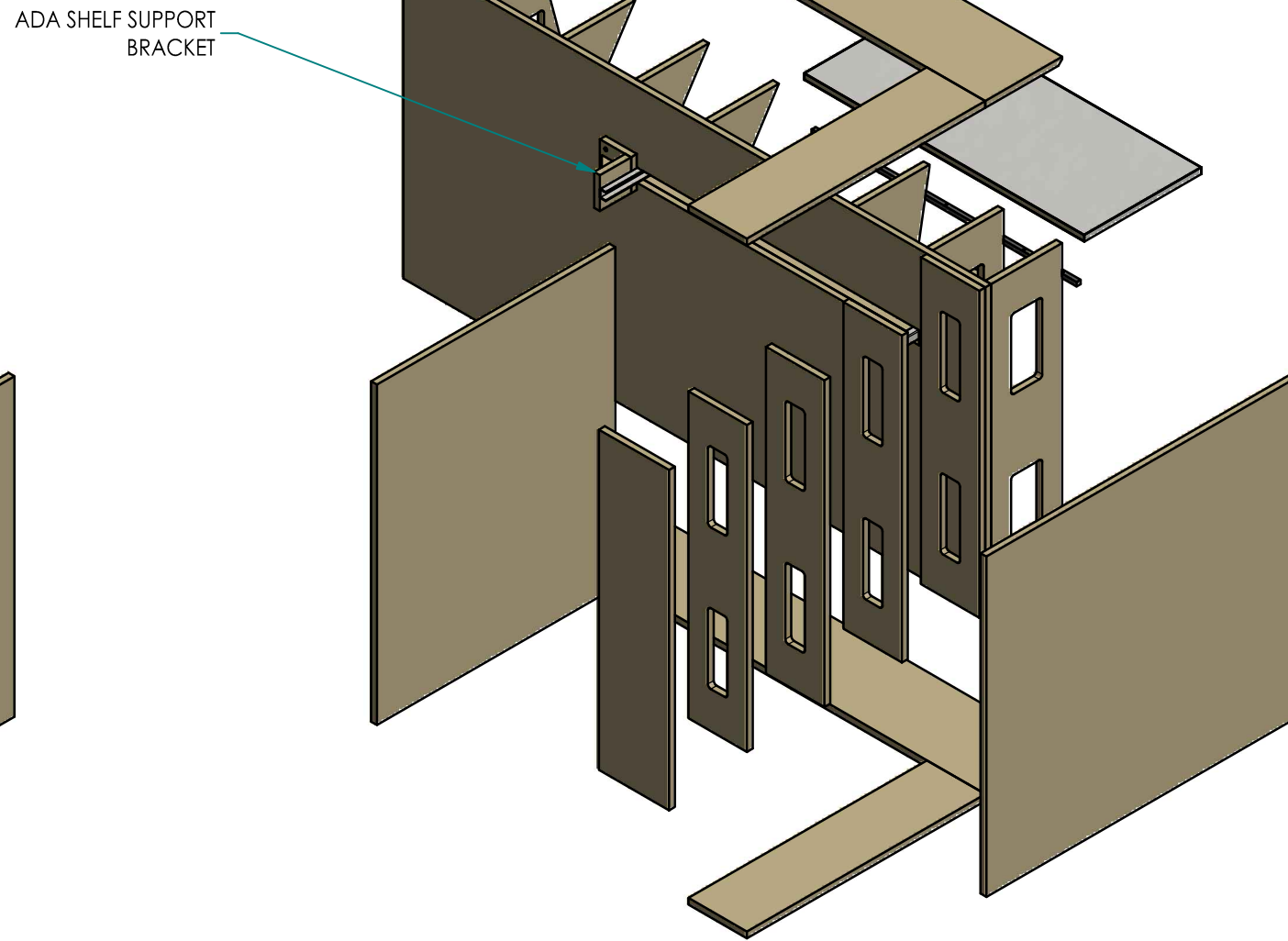

**EXPLODED ISOMETRIC
FRAMING**

RETAIL

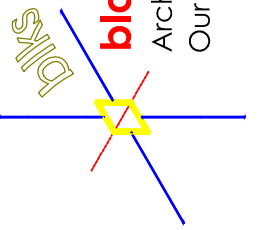

blacks outsourcing, inc.
Architectural Woodwork Engineering
Our business is drawing yours

FIXTURE SHIPS FULLY ASSEMBLED
PLEASE BE AWARE WEIGHT OF
FIXTURE COULD BE ISSUE

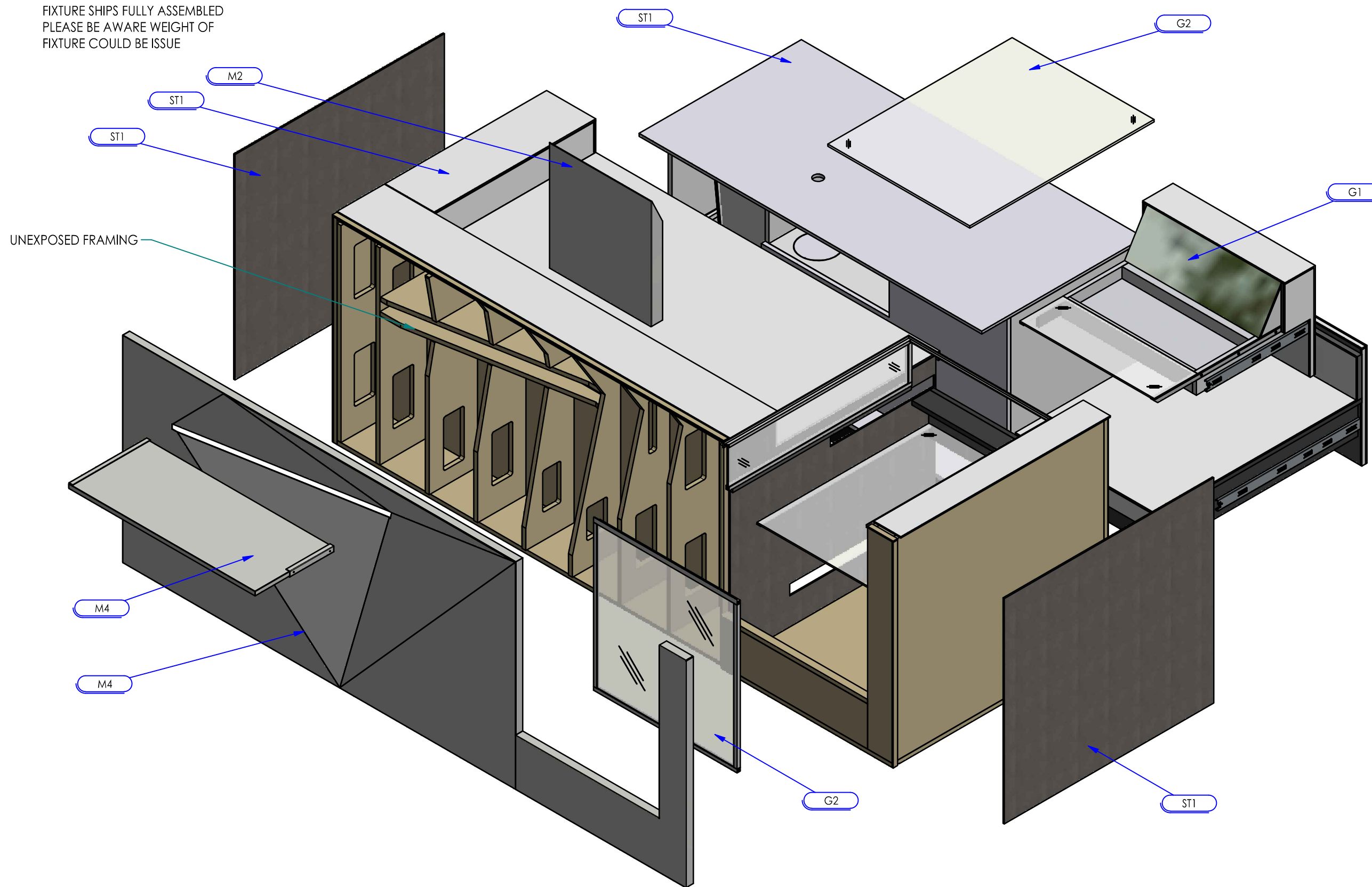

RETAIL



blks outsourcing, inc.
Architectural Woodwork Engineering
Our business is drawing yours

EXPLODED ISOMETRIC
CUSTOMER SIDE

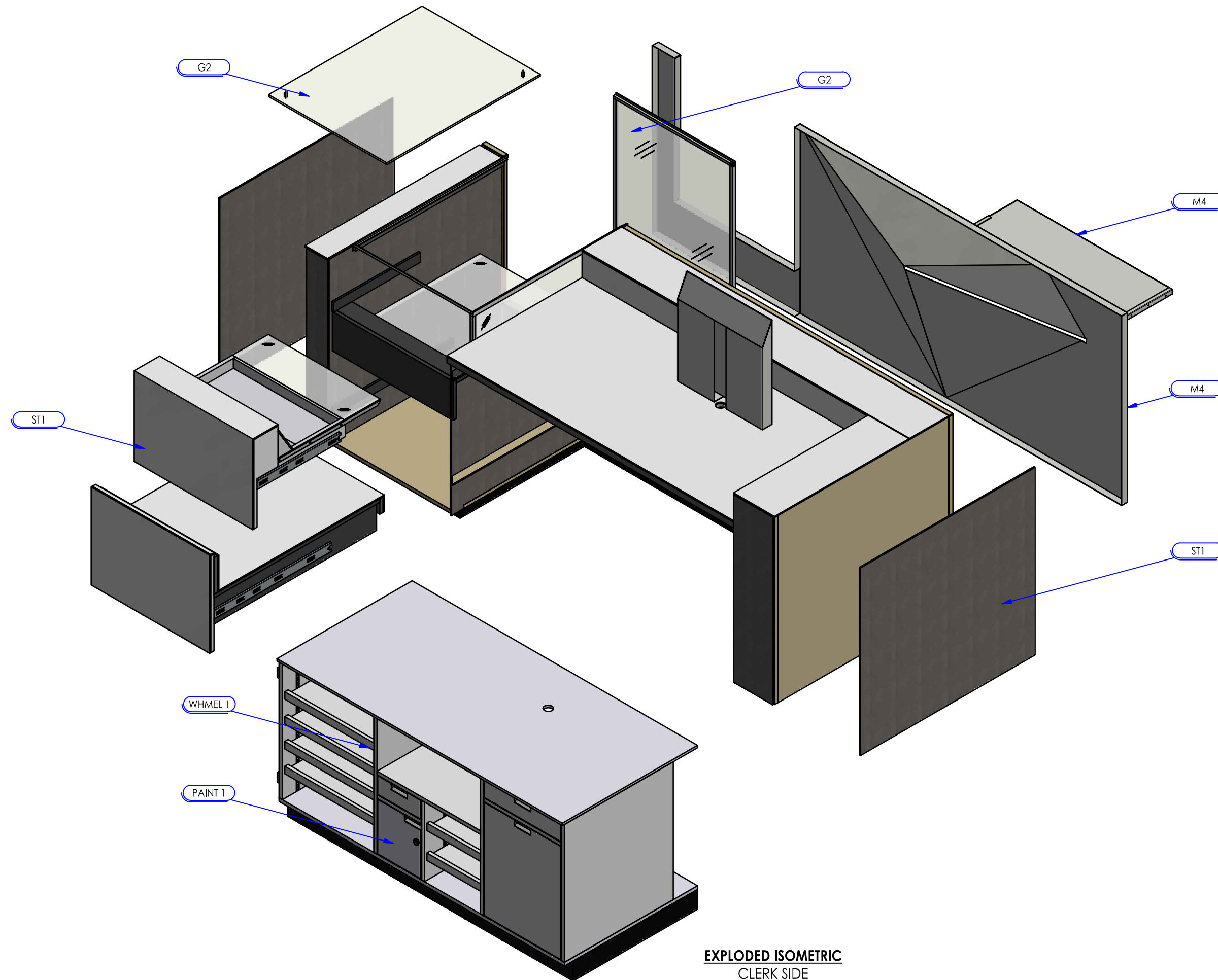

EXPLODED ISOMETRIC
CLERK SIDE

RETAIL

